

Woodbridge Road

KNOWLE

APPROXIMATE FLOOR AREA
152.9 SQM / 1646 SQFT



GROUND FLOOR
686 sq.ft. (63.7 sq.m.) approx.

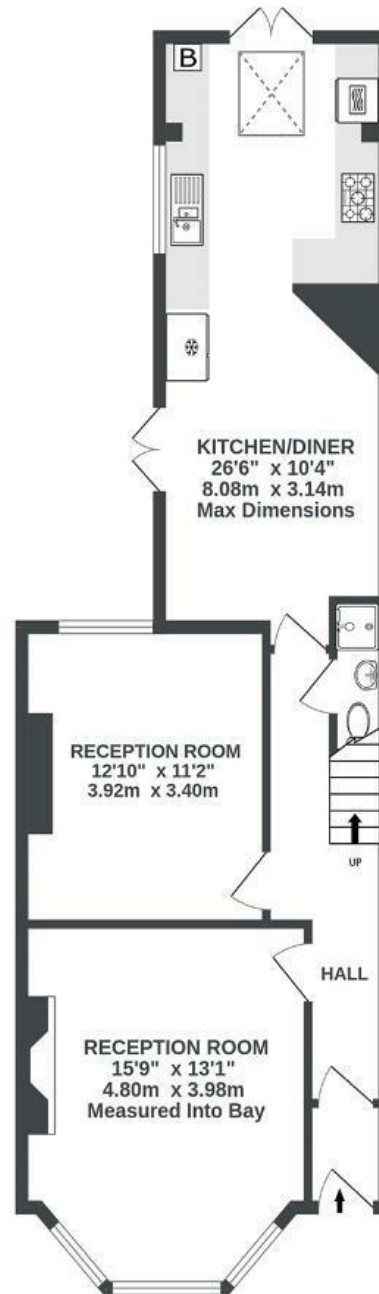

1ST FLOOR
664 sq.ft. (61.7 sq.m.) approx.



2ND FLOOR
296 sq.ft. (27.5 sq.m.) approx.

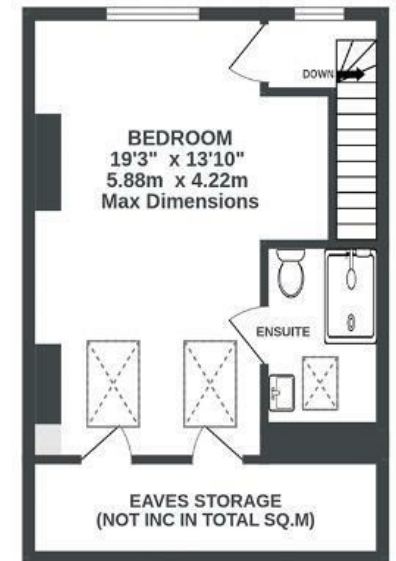

Illustrations are for reference purposes only, measurements are approximate, not to scale.

~~Boardwalk~~

Woodbridge , BRISTOL



£650,000



BS4 2EU



4 Bedrooms



2 Bathrooms

"This had been our family home for many years and now it's time for someone new to create some more memories here. It's in a great spot – just a short stroll to Wells Road, Hill Crest Primary school, Redcatch Park and there is a really friendly, welcoming community. I might be biased but it's a fantastic home for families looking for space and charm."

